



# Nera C

## INMARSAT C MOBILE EARTH STATION



Full coverage of Inmarsat-C services:  
EGC, Internet E-mail, distress message handling, polling and data reporting



# Technical specifications

## Rules and Regulations

Complies with IMO Res. A.807 (19) Inmarsat-C, A.664 (16) EGC Performance Standards, A.694 (17) General requirements, MSC.68 (68), MSC/Circ 862, MSC 55/25 Inmarsat, IEC 61097-4 Inmarsat-C/EGC

## Class Identification

Nera C is Class 2 Inmarsat-C SES

(For info Class 0: EGC, Class 1: Basic SES, Class 2: Basic SES + EGC, Class 3: Basic SES + independent EGC)

## Inmarsat-C Services Supported

- EGC receiving (SafetyNET™, FleetNET™)
- Distress message handling
- Two-way, digital store-and-forward message handling: Telex, FAX(PSTN), Internet E-mail, X.25 (PSDN), X.400(MHS), Closed Network (DNID), Special Access Code
- Polling, Data Reporting

## Frequency

TX: 1626.5 - 1646.5 MHz

RX: 1530.0 - 1545.0 MHz

## Channel Spacing

5 kHz

## Modulation

BPSK 600/1200 symbols/s

## Output Power

17 W at final amplifier

## Editing

Message editing, File protection by password, Easy editing by cut, paste, copy, search and replace commands.

## File Management

Adding, modifying and deleting, List and print files, Available memory count, Transferring data between memory and floppydisk.

## Utility Programs

System status indication, System diagnostic, Performance verification test (PVT), Commissioning sequence, Station list, Log book

## Interface

RS-232C 1 port for EGC printer, PC

Ethernet 10Base-T 1 port for PC or LAN

IEC 61162 1 port BWC, BWR, DBT, GGA, GSV, GLL, MTW, RMA, RMB, RMC, WPL, VDR, VTG, ZDA

## Display Unit IC-215

Display: 10.4" color LCD (207 x 160 mm)

Message: 72 characters/line, 25 lines/screen

## Printer PP-510

Mandatory for EGC operation as required by IMO Res. A.664 (16).

Printing paper

Rolled, impact dot, 216 mm wide, 80 characters/line

## Power Supply

12-24 VDC, 160 W (TX), 75 W (RX)

## Environment

(IEC 60945 test method)

Temperature

-15°C to +55°C (Protected units)

-25°C to +70°C (Exposed units)

## Equipment List

### Standard

- |  |        |
|--|--------|
| 1. Antenna Unit w/GPS                    | 1 unit |
| 2. 30 m Antenna Cable                    | 1 unit |
| 3. Terminal Unit with Keyboard           | 1 unit |
| 4. Junction Box                          | 1 unit |
| 5. Distress Alert/Received Call Unit     | 1 unit |
| 6. Alarm Unit                            | 1 unit |
| 7. Installation Materials and Spare Fuse |        |

### Option

1. Printer PP-510
2. Software for PC
3. Antenna Cable 8D-FB-CV (50 m), 12D-FB-CV (100 m)
4. AC/DC Power Supply Unit PR-240\*

\* Required for EGC, IMO Res. A.664 (16)/4 to operate on ship's mains

## INTERCONNECTION DIAGRAM

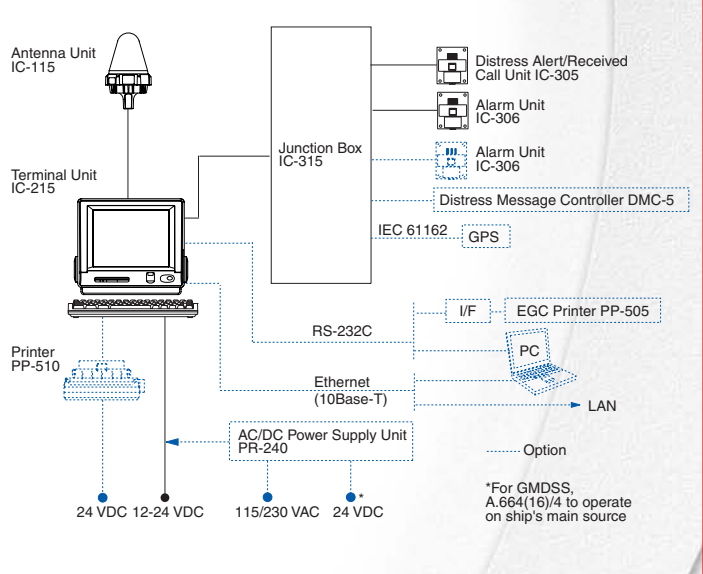

## Antenna Unit IC-115

1.4 kg 3.1 lb

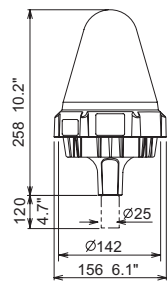

## Terminal Unit IC-215

4.5 kg 9.9 lb

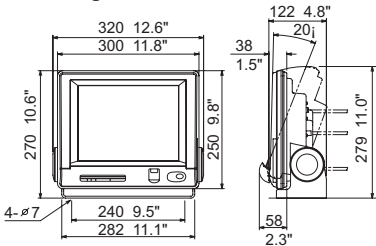

## Junction Box IC-315 0.7 kg 1.5 lb

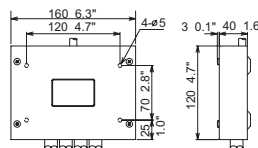

## Printer PP-510 3.3 kg 7.3 lb

(optional)

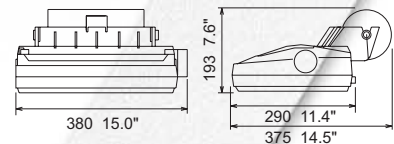

## Alarm Unit IC-306

0.33 kg 0.7 lb

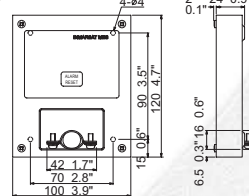

## Distress Alert/Received Call Unit IC-305

0.34 kg 0.8 lb

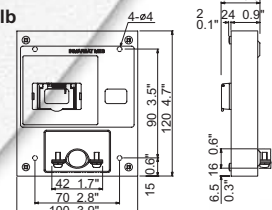

## Nera SatCom AS

Bergerveien 12, PO Box 91 N-1375 Billingstad, Norway

Tel: +47 67 24 47 00 Fax: +47 67 24 46 26

E-mail: nera@nera.no

www.neraworld.com

